

# ADDENDUM - Storage units - Laminate

## Laminate fixed low storage units

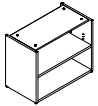

Open low storage unit

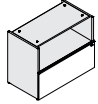

Pigeonhole/file drawer low storage unit

Specify handle and laminate color codes.

Specification	Code	W x D x H (in)	W x D x H (mm)	Price
Open storage	VBEL-202928	29-7/16 x 19-5/16 x 28	748 x 490 x 711	710
	VBEL-203528	35-3/8 x 19-5/16 x 28	898 x 490 x 711	765
Pigeonhole/file drawer	VSLFL-202928	29-7/16 x 20 x 28	748 x 508 x 711	1,270
	VSLFL-203528	35-3/8 x 20 x 28	898 x 508 x 711	1,320

### Specification notes

Lock and handle are the same color.  
Includes suspension bar (left-right), letter and legal format.  
The open low storage unit (VBEL) includes 1 adjustable shelf.  
Fixed storage units must be attached under a work surface equal to or deeper than 20" (508 mm).

Handle/lock colors	Sample order
N Black S Silver	VBEL- 20 29 28 - N, G-ACA, G-GAN
	Product code   Depth   Width   Height   Handle/lock color   Laminate color   Front laminate color

## Laminate low storage units

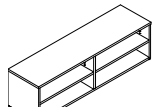

Open low storage unit

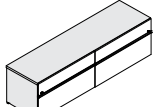

2 utility/2 file drawers low storage unit

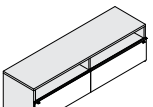

2 pigeonholes/2 file drawers low storage unit

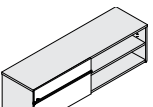

Utility/file drawer on left, open on right low storage unit

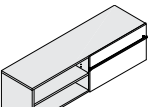

Utility/file drawer on right, open on left low storage unit

Specify handle and laminate color codes.

Specification	Code	W x D x H (in)	W x D x H (mm)	Price	
				Thermofused laminate	High-pressure laminate
Open storage	VBEBE-204720	47-1/4 x 19-5/16 x 20	1200 x 490 x 513	1,000	1,100
	VBEBE-205920	59-1/16 x 19-5/16 x 20	1500 x 490 x 513	1,080	1,180
	VBEBE-207120	70-7/8 x 20 x 20	1800 x 490 x 513	1,160	1,260
2 utility/2 file drawers	VULUL-204720	47-1/4 x 20 x 20	1200 x 508 x 513	2,300	2,410
	VULUL-205920	59-1/16 x 20 x 20	1500 x 508 x 513	2,410	2,520
	VULUL-207120	70-7/8 x 20 x 20	1800 x 508 x 513	2,520	2,630
2 pigeonholes/2 file drawers	VSLF-204720	47-1/4 x 20 x 20	1200 x 508 x 513	1,840	1,950
	VSLF-205920	59-1/16 x 20 x 20	1500 x 508 x 513	1,940	2,050
	VSLF-207120	70-7/8 x 20 x 20	1800 x 508 x 513	2,040	2,150
1 utility/1 file drawer on left, open on right	VULBE-204720	47-1/4 x 20 x 20	1200 x 508 x 513	1,430	1,540
	VULBE-205920	59-1/16 x 20 x 20	1500 x 508 x 513	1,455	1,565
	VULBE-207120	70-7/8 x 20 x 20	1800 x 508 x 513	1,525	1,635
1 utility/1 file drawer on right, open on left	VBEUL-204720	47-1/4 x 20 x 20	1200 x 508 x 513	1,430	1,540
	VBEUL-205920	59-1/16 x 20 x 20	1500 x 508 x 513	1,455	1,565
	VBEUL-207120	70-7/8 x 20 x 20	1800 x 508 x 513	1,525	1,635

### Specification notes

Available in thermofused or high pressure laminate.  
Lock and handle are the same color.  
Includes suspension bar (left-right), letter and legal format.  
Pencil tray is included in utility drawer.  
The open low storage unit (VBEBE) includes 2 adjustable shelves.  
The combined open low storage units (VULBE and VBEUL) includes 1 adjustable shelf.  
Can accommodate 1 or 2 cushions. Order separately (refer to page 2).  
May be placed under a cantilever.

Laminate options	Handle/lock colors	Sample order
1 Thermofused laminate 2 High pressure laminate	N Black S Silver	VBEBE- 20 47 20 - 1 N, G-ACA, G-GAN
		Product code   Depth   Width   Height   Laminate option   Handle/lock color   Laminate color   Front laminate color

# ADDENDUM - Storage units - Laminate

## Cushions for low storage units

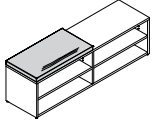

Specify upholstery color code; refer to current grades 1 to 3 from United Chair and Arold seating upholstery cards.

Specification	Code	W x D x H (in)	W x D x H (mm)	Price
Recommended for units 47" L (1200 mm)	VCU-2023	23-5/8 x 19-5/16 x 2	600 x 490 x 50	475
Recommended for units 59" L (1500 mm)	VCU-2029	29-1/2 x 19-5/16 x 2	750 x 490 x 50	490
Recommended for units 71" L (1800 mm)	VCU-2035	35-7/16 x 19-5/16 x 2	900 x 490 x 50	505

### Specification notes

These prices are applicable for United Chair Grade 1 fabrics. For other grades, add: Grade 2: 10%; Grade3: 15%.  
Hook-and-loop fastener included.  
For use on a 20" (508 mm) deep low storage unit.  
Low storage units may accommodate 1 or 2 cushions.

### Sample order

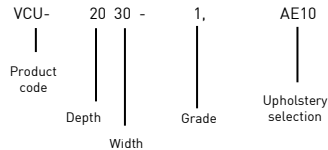

## Center-mounted open laminate overhead units

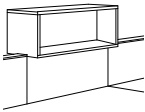

Single overhead unit  
Width: 24", 30", 36", 42"

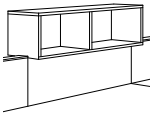

Double overhead unit  
Width: 48", 54", 60"

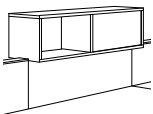

Shared overhead unit  
Width: 42", 48", 54", 60"

Hardware kit included.

Specify support and laminate color codes.

Specification	Code	W x D x H (in)	W x D x H (mm)	Price
Single	VEP-1624	24 x 13-3/4 x 15-3/4	610 x 350 x 400	545
	VEP-1630	30 x 13-3/4 x 15-3/4	762 x 350 x 400	560
	VEP-1636	36 x 13-3/4 x 15-3/4	914 x 350 x 400	580
	VEP-1642	42 x 13-3/4 x 15-3/4	1067 x 350 x 400	595
Double	VEP-1648	48 x 13-3/4 x 15-3/4	1219 x 350 x 400	690
	VEP-1654	54 x 13-3/4 x 15-3/4	1372 x 350 x 400	710
	VEP-1660	60 x 13-3/4 x 15-3/4	1524 x 350 x 400	730
Shared	VDEP-1642	42 x 13-3/4 x 15-3/4	1067 x 350 x 400	620
	VDEP-1648	48 x 13-3/4 x 15-3/4	1219 x 350 x 400	650
	VDEP-1654	54 x 13-3/4 x 15-3/4	1372 x 350 x 400	680
	VDEP-1660	60 x 13-3/4 x 15-3/4	1524 x 350 x 400	710

### Specification notes

Accepts separately specified task light units (refer to Nvision Price List - January 2013, page 77).  
For additional information on how to specify panel components, refer to page 9.  
Field assembly required.

### Bracket/metal colors

TR-K Charcoal  
TR-R Beige  
TR-LE Metallic Silver

### Sample order

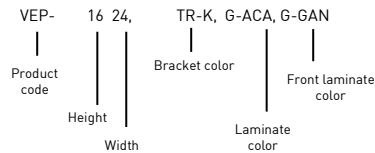

## Center-mounted laminate overhead units with a flipper door (standard hinges)

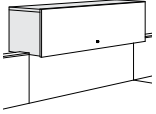

Hardware kit included.  
Specify support and laminate color codes.

Specification	Code	W x D x H (in)	W x D x H (mm)	Price
Flipper door	VEPP-1624	24 x 14-1/2 x 16-1/4	610 x 368 x 413	715
	VEPP-1630	30 x 14-1/2 x 16-1/4	762 x 368 x 413	740
	VEPP-1636	36 x 14-1/2 x 16-1/4	914 x 368 x 413	760
	VEPP-1642	42 x 14-1/2 x 16-1/4	1067 x 368 x 413	785
	VEPP-1648	48 x 14-1/2 x 16-1/4	1219 x 368 x 413	890
	VEPP-1654	54 x 14-1/2 x 16-1/4	1372 x 368 x 413	910
	VEPP-1660	60 x 14-1/2 x 16-1/4	1524 x 368 x 413	930

### Specification notes

For additional information on how to specify panel components, refer to page 9.  
When ordering TR-LE, the lock will automatically be silver.  
When ordering TR-K or TR-R, the lock will automatically be black.  
Accepts separately specified task light units (refer to Nvision Price List – January 2013, page 77).  
Door is stored on top of unit, when opened.  
Field assembly required.

### Bracket/metal colors

TR-K Charcoal  
TR-R Beige  
TR-LE Metallic Silver

### Sample order

VEPP- 16 24, TR-K G-ACA, G-GAN  
 | | | | |  
 Product code Height Width Bracket color Laminate color Front laminate color

## Center-mounted laminate overhead units with a flipper door (soft close hinges)

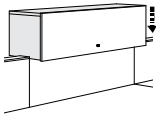

Soft close hinges

Hardware kit included.  
Specify support and laminate color codes.

Specification	Code	W x D x H (in)	W x D x H (mm)	Price
Flipper door with soft close hinges	VEPP-1624-S	24 x 14-1/2 x 16-1/4	610 x 368 x 413	835
	VEPP-1630-S	30 x 14-1/2 x 16-1/4	762 x 368 x 413	860
	VEPP-1636-S	36 x 14-1/2 x 16-1/4	914 x 368 x 413	880
	VEPP-1642-S	42 x 14-1/2 x 16-1/4	1067 x 368 x 413	905
	VEPP-1648-S	48 x 14-1/2 x 16-1/4	1219 x 368 x 413	1,010
	VEPP-1654-S	54 x 14-1/2 x 16-1/4	1372 x 368 x 413	1,030
	VEPP-1660-S	60 x 14-1/2 x 16-1/4	1524 x 368 x 413	1,050

### Specification notes

For additional information on how to specify panel components, refer to page 9.  
When ordering TR-LE, the lock will automatically be silver.  
When ordering TR-K or TR-R, the lock will automatically be black.  
Accepts separately specified task light units (refer to Nvision Price List – January 2013, page 77).  
Door is stored on top of unit, when opened.  
Field assembly required.

### Bracket/metal colors

TR-K Charcoal  
TR-R Beige  
TR-LE Metallic Silver

### Sample order

VEPP- 16 24- S, TR-K G-ACA, G-GAN  
 | | | | |  
 Product code Height Width Soft close Bracket color Laminate code Front laminate code

# ADDENDUM - Storage units - Laminate

## Wardrobe units

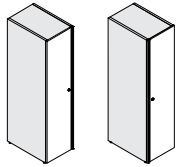

Hinges on left  
Hinges on right

Specify handle and laminate color codes.

Specification	Code	W x D x H (in)	W x D x H (mm)	Price
Hinges on left	VCL-1650-L	16 x 24 x 50	406 x 610 x 1264	1,230
	VCL-1656-L	16 x 24 x 56	406 x 610 x 1422	1,260
	VCL-1664-L	16 x 24 x 64	406 x 610 x 1620	1,290
	VCL-1668-L	16 x 24 x 68	406 x 610 x 1721	1,325
Hinges on right	VCR-1650-R	16 x 24 x 50	406 x 610 x 1264	1,230
	VCR-1656-R	16 x 24 x 56	406 x 610 x 1422	1,260
	VCR-1664-R	16 x 24 x 64	406 x 610 x 1620	1,290
	VCR-1668-R	16 x 24 x 68	406 x 610 x 1721	1,325

### Specification notes

Lock and handle are the same color.  
Wardrobe with clothes hanger bar and fixed shelf.

Handle/lock colors	Sample order
N Black S Silver	VCL- 16 50 - L N, G-ACA, G-GAN
	Product code   Width   Height   Opening (hinges)   Handle/lock color   Laminate code   Front laminate code

## Wardrobe units with open bookcase

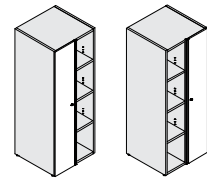

Hinges on left  
Hinges on right

Specify handle and laminate color codes.

Specification	Code	W x D x H (in)	W x D x H (mm)	Price
Hinges on left	VCBE-2450-L	24 x 24 x 50	610 x 610 x 1264	1,675
	VCBE-2456-L	24 x 24 x 56	610 x 610 x 1422	1,800
	VCBE-2464-L	24 x 24 x 64	610 x 610 x 1620	1,885
	VCBE-2468-L	24 x 24 x 68	610 x 610 x 1721	1,950
Hinges on right	VBEC-2450-R	24 x 24 x 50	610 x 610 x 1264	1,675
	VBEC-2456-R	24 x 24 x 56	610 x 610 x 1422	1,800
	VBEC-2464-R	24 x 24 x 64	610 x 610 x 1620	1,885
	VBEC-2468-R	24 x 24 x 68	610 x 610 x 1721	1,950

### Specification notes

Lock and handle are the same color.  
Wardrobe with clothes hanger bar and fixed shelf.  
Adjustable shelves; 50" H (1264 mm) 2 shelves, 56" H (1422 mm) and 64" H (1620 mm) 3 shelves, 68" H (1721 mm) 4 shelves.

Handle/lock colors	Sample order
N Black S Silver	VBEC- 24 50 - R N, G-ACA, G-GAN
	Product code   Width   Height   Opening (hinges)   Handle/lock color   Laminate code   Front laminate code

# ADDENDUM - Storage units - Laminate

## Personal laminate storage towers with open bookcase

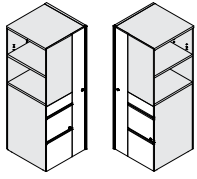

Open bookcase on left  
Open bookcase on right

Specify handle and laminate color codes.

Specification	Code	W x D x H (in)	W x D x H (mm)	Price
Open bookcase on left	VPB-2450-L	24 x 24 x 50	610 x 610 x 1264	1,720
	VPB-2456-L	24 x 24 x 56	610 x 610 x 1422	1,820
	VPB-2464-L	24 x 24 x 64	610 x 610 x 1620	1,920
Open bookcase on right	VPB-2450-R	24 x 24 x 50	610 x 610 x 1264	1,720
	VPB-2456-R	24 x 24 x 56	610 x 610 x 1422	1,820
	VPB-2464-R	24 x 24 x 64	610 x 610 x 1620	1,920

### Specification notes

Locks and handles are the same color.  
Locks on door and drawers.  
Includes suspension bar (left-right), letter and legal format.  
Pencil tray is included in utility drawer.  
Wardrobe with clothes hanger bar and fixed shelf.  
Adjustable shelf on 56"H (1422 mm) and 64"H (1620 mm).

Handle/lock colors	Sample order
N Black S Silver	VPB- 24 50- R N, G-ACA, G-GAN Product code   Width   Height   Open bookcase side   Handle/lock color   Laminate color   Front laminate color

## Personal laminate storage towers with open bookcase and white board

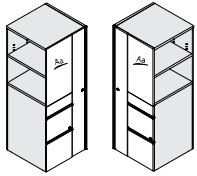

Open bookcase on left  
Open bookcase on right

Specify handle and laminate color codes.

Specification	Code	W x D x H (in)	W x D x H (mm)	Price
Open bookcase on left	VPBW-2450-L	24 x 24 x 50	610 x 610 x 1264	1,770
	VPBW-2456-L	24 x 24 x 56	610 x 610 x 1422	1,870
	VPBW-2464-L	24 x 24 x 64	610 x 610 x 1620	1,970
Open bookcase on right	VPBW-2450-R	24 x 24 x 50	610 x 610 x 1264	1,770
	VPBW-2456-R	24 x 24 x 56	610 x 610 x 1422	1,870
	VPBW-2464-R	24 x 24 x 64	610 x 610 x 1620	1,970

### Specification notes

Non-magnetic white board.  
Locks and handles are the same color.  
Locks on door and drawers.  
Includes suspension bar (left-right), letter and legal format.  
Pencil tray is included in utility drawer.  
Wardrobe with clothes hanger bar and fixed shelf.  
Adjustable shelf on 56" (1422 mm) and 64" (1620 mm) high.

Handle/lock colors	Sample order
N Black S Silver	VPBW- 24 50 R N, G-ACA, G-GAN Product code   Width   Height   Open bookcase side   Handle/lock color   Laminate color   Front laminate color

# ADDENDUM - Accessories

## Shelves

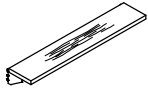

Hardware kit included.  
Specify support and laminate color codes.

Specification	Code	W x D x H (in)	W x D x H (mm)	Price	
				Thermofused laminate	High pressure laminate
	VSH-0724	24 x 7 x 1	610 x 177 x 25	195	210
	VSH-0730	30 x 7 x 1	762 x 177 x 25	200	220
	VSH-0736	36 x 7 x 1	914 x 177 x 25	205	230

### Specification notes

Available in thermofused laminate or high pressure laminate.  
Field assembly required.

Laminate options	Bracket/metal colors	Sample order
1 Thermofused laminate 2 High pressure laminate	TR-K Charcoal TR-R Beige TR-LE Metallic Silver	VSH- 07 24- 1, TR-K, G-ACA Product code   Depth   Width   Laminate option   Bracket color   Laminate code

## Modesty panels

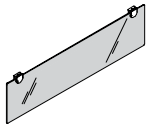

Frosted acrylic modesty panels

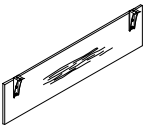

Thermofused laminate modesty panels

Hardware kit included.  
Specify laminate color code.

Specification	Code	W x D x H (in)	W x D x H (mm)	Price
<b>Frosted acrylic</b>				
Screen height: 12" (305 mm)	VMODT-1236, SK-1E	36 x 1/4 x 12	914 x 6 x 305	340
	VMODT-1248, SK-1E	48 x 1/4 x 12	1219 x 6 x 305	390
<b>Thermofused laminate</b>				
Screen height: 12" (305 mm)	VMOD-1236	36 x 1/4 x 12	914 x 6 x 305	185
	VMOD-1248	48 x 1/4 x 12	1219 x 6 x 305	200

### Specification notes

Satin chrome brackets included with frosted acrylic modesty panels.  
Anthracite grey brackets included with thermofused laminate modesty panels.  
To be installed on the straight side of a work surface which is 36" (914 mm) or wider.  
Field assembly required.

Frosted acrylic sample order			Thermofused laminate sample order		
VMODT- 12 36, SK-1E			VMODT- 12 36, G-ACA		
Product code   Height   Width   Acrylic			Product code   Height   Width   Laminate code		

## Lateral privacy screens

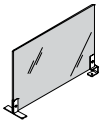

Hardware kit included.  
Specify support color code.

Specification	Code	W x D x H (in)	W x D x H (mm)	Price
<b>Frosted acrylic</b>				
Screen height: 15" (381 mm)	VSCCT-2315, SK-1E	22-7/16 x 1/4 x 15	570 x 6 x 381	285
	VSCCT-2915, SK-1E	28-7/16 x 1/4 x 15	722 x 6 x 381	310
Screen height: 19" (482 mm)	VSCCT-2319, SK-1E	22-7/16 x 1/4 x 19	570 x 6 x 482	320
	VSCCT-2919, SK-1E	28-7/16 x 1/4 x 19	722 x 6 x 482	340

### Specification notes

Stabilizer foot and metal clip included.  
To be installed on a work surface equal to or deeper than 24" (610 mm).  
Field assembly required.

Bracket/metal colors	Sample order
TR-K Charcoal TR-R Beige TR-LE Metallic Silver	VSCCT- 23 15, SK-1E, TR-K Product code   Width   Height   Acrylic   Bracket color

## Modular modesty panels

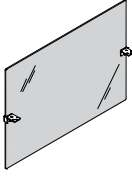

Hardware kit included.  
Specify support color code.

Specification	Code	W x D x H (in)	W x D x H (mm)	Price
<b>Frosted acrylic</b>				
<b>Screen height: 24" (610 mm)</b>	VSCT-2424, SK-1E	24 x 1/4 x 24	610 x 6 x 610	530
	VSCT-2430, SK-1E	30 x 1/4 x 24	762 x 6 x 610	570
	VSCT-2436, SK-1E	36 x 1/4 x 24	914 x 6 x 610	610
	VSCT-2442, SK-1E	42 x 1/4 x 24	1067 x 6 x 610	650
	VSCT-2448, SK-1E	48 x 1/4 x 24	1219 x 6 x 610	690
<b>Screen height: 30" (762 mm)</b>	VSCT-3030, SK-1E	30 x 1/4 x 30	762 x 6 x 762	625
	VSCT-3036, SK-1E	36 x 1/4 x 30	914 x 6 x 762	665
	VSCT-3042, SK-1E	42 x 1/4 x 30	1067 x 6 x 762	705
	VSCT-3048, SK-1E	48 x 1/4 x 30	1219 x 6 x 762	745

### Specification notes

Metal support included.  
To be installed on the straight side of a work surface which is 36" (914 mm) or wider.  
Field assembly required.

Bracket/metal colors	Sample order
TR-K Charcoal TR-R Beige TR-LE Metallic Silver	VSCT- 24 30, SK-1E, TR-K Product code   Height   Width   Acrylic   Bracket color

## Panel privacy screens

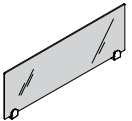

Hardware kit included.

Specification	Code	W x D x H (in)	W x D x H (mm)	Price
<b>Frosted acrylic</b>				
<b>Screen height: 8" (203 mm)</b>	VSAGX-0824, SK-1E	22-3/8 x 1/4 x 8	569 x 6 x 203	270
	VSAGX-0830, SK-1E	28-3/8 x 1/4 x 8	721 x 6 x 203	300
	VSAGX-0836, SK-1E	34-3/8 x 1/4 x 8	873 x 6 x 203	330
	VSAGX-0842, SK-1E	40-3/8 x 1/4 x 8	1026 x 6 x 203	360
	VSAGX-0848, SK-1E	46-7/16 x 1/4 x 8	1179 x 6 x 203	390
	VSAGX-0854, SK-1E	52-3/8 x 1/4 x 8	1331 x 6 x 203	420
	VSAGX-0860, SK-1E	58-3/8 x 1/4 x 8	1483 x 6 x 203	450
	<b>Screen height: 10" (254 mm)</b>	VSAGX-1024, SK-1E	22-3/8 x 1/4 x 10	569 x 6 x 254
VSAGX-1030, SK-1E		28-3/8 x 1/4 x 10	721 x 6 x 254	320
VSAGX-1036, SK-1E		34-3/8 x 1/4 x 10	873 x 6 x 254	355
VSAGX-1042, SK-1E		40-3/8 x 1/4 x 10	1026 x 6 x 254	390
VSAGX-1048, SK-1E		46-7/16 x 1/4 x 10	1179 x 6 x 254	425
VSAGX-1054, SK-1E		52-3/8 x 1/4 x 10	1331 x 6 x 254	460
VSAGX-1060, SK-1E		58-3/8 x 1/4 x 10	1483 x 6 x 254	495
<b>Screen height: 14" (355 mm)</b>		VSAGX-1424, SK-1E	22-3/8 x 1/4 x 14	569 x 6 x 355
	VSAGX-1430, SK-1E	28-3/8 x 1/4 x 14	721 x 6 x 355	350
	VSAGX-1436, SK-1E	34-3/8 x 1/4 x 14	873 x 6 x 355	390
	VSAGX-1442, SK-1E	40-3/8 x 1/4 x 14	1026 x 6 x 355	430
	VSAGX-1448, SK-1E	46-7/16 x 1/4 x 14	1179 x 6 x 355	470
	VSAGX-1454, SK-1E	52-3/8 x 1/4 x 14	1331 x 6 x 355	510
	VSAGX-1460, SK-1E	58-3/8 x 1/4 x 14	1483 x 6 x 355	550

### Specification notes

Cables cannot be routed along the top channel of the frame where the screen is attached.  
Satin chrome brackets included.  
Field assembly required.

Sample order
VSAGX- 08 14, SK-1E Product code   Height   Width   Acrylic

# ADDENDUM - Storage units - Laminate

## Specifications and recommendations – Storage units

### Two-tone applications

- ▶ The first finish specified will be applied to the frame of the unit. The second finish will be applied to the unit's front.
- ▶ Two-tone application and wood grain direction:

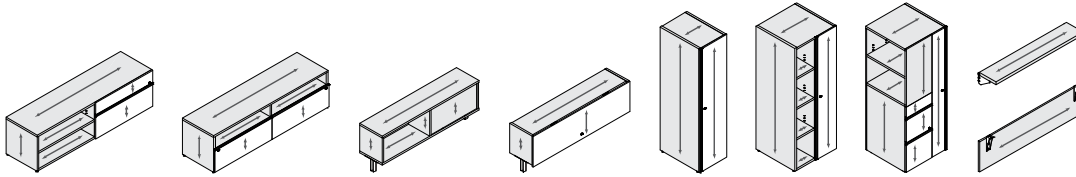

### Height management

Configuration examples for 50" (1270 mm) high panel:

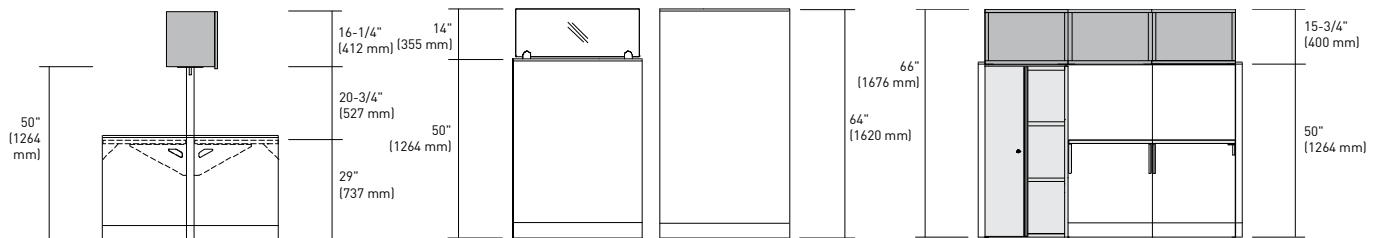

### Uses: Recommendations and best practices for center-mounted overhead units and panel privacy screens

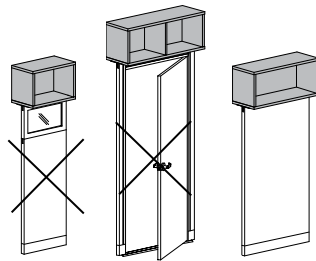

The overhead unit needs to be installed on an acoustical panel/stack.

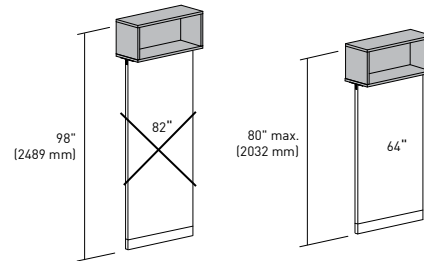

The maximal height for a combination overhead/panel is 80" (2032 mm).

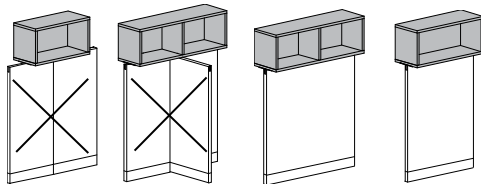

The overhead unit's width needs to be equal to the total width of the panels on which the overhead unit is installed.

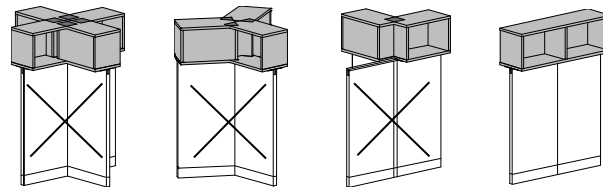

Depending on the configuration, it is important to make sure that the overhead units do not conflict with each other.

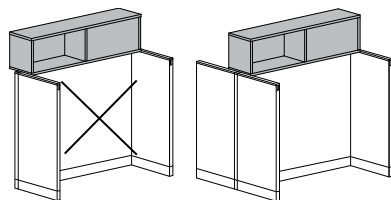

**Important:** The overhead units need to be supported by return panels on both sides.

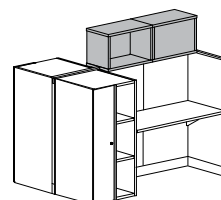

**Options:** The overhead units need to be supported by vertical storage units which are of equal height or higher than the panels on which the overhead units are installed.



## Specifications and recommendations – Storage units

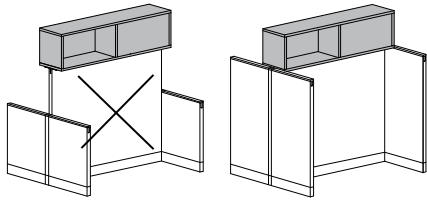

**Without work surface:** Return panels must be of equal height to the panels on which the overhead units are installed.

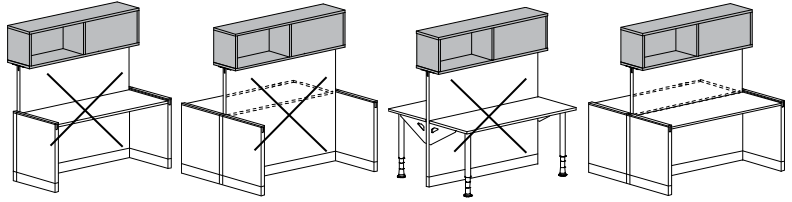

**With work surfaces:** It is possible to use return panels that are lower than the panels on which the overhead units are installed. To do so, there must be a work surface on both sides of the panel.

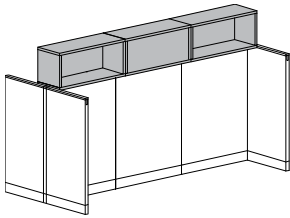

Generally, a panel run with overhead units is maximum 10' (3048 mm).

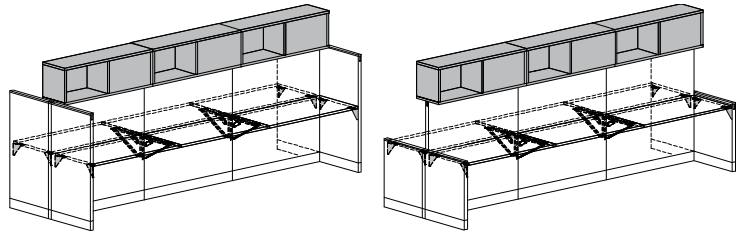

A panel run with overhead units can be up to 12' (3658 mm) if work surfaces are installed on both sides of the panel and all along the panel run. In this case, the ends must be fixed using panel brackets. Return panels can be 30" (762 mm) or wider.

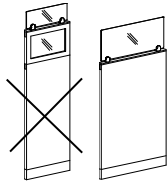

Panel privacy screens can only be installed on acoustical panels.

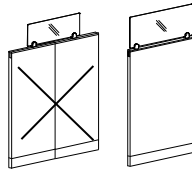

Panel privacy screens must have an equal width to the panel on which it is installed. The screen can only be installed on one panel at a time, which means that it cannot overlap two or more panels.

### Finishing touches for overhead configurations

The finishing touches are key components for the esthetics and configuration of the product. When specifying a laminate overhead, care must be taken in selecting these components.

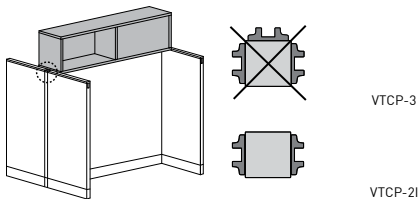

180 degrees panel junction configuration.

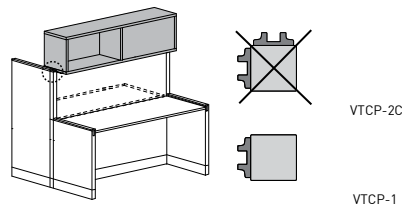

90 degrees panel junction configuration.

### Non-recommended configurations

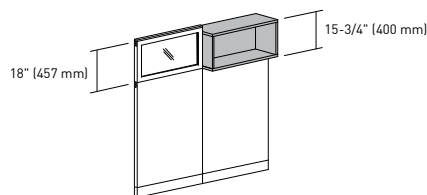
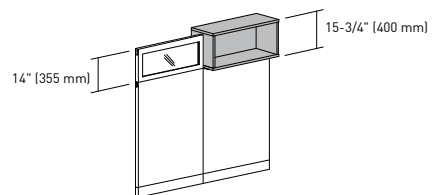

All metal and laminate overhead units are 15-3/4" (400 mm), which results in a homogenous appearance. In order to create the desired effect, care must be taken when specifying the combination of products.